



EIO PRESS



**PP
Compression
Fittings**

THE COMPANY

In October 2015, **Nupi Industrie Italiane S.p.A.** took over **Nupigeco S.p.A.** The name change brings with it an 'all-Italian' company that exports its products worldwide.



Nupigeco S.p.A. was founded on October 1st 2008 by the merger of two of our companies, **NUPI S.p.A.** and **Geco System S.p.A.** - both founded more than 30 years ago. Combining their many years of experience and constant growth, the two firms decided to create a new flexible and advanced company, ready to play its role to satisfy the demands of the market whilst being environmentally astute.

"The height you attend depends on the depth of your roots"

Nupi Industrie Italiane S.p.A. develops and produces pipe and fitting systems for plumbing, heating, air conditioning, irrigation, water and gas pipelines. Nupi Industrial Division (NUPI ID), which was founded in 1995, is dedicated to the production of the highest quality multilayer pipes specifically designed for the petroleum, oil, chemical and petrochemical markets.

Today, **Nupi Industrie Italiane S.p.A.** offers a complete range of

pipes and fittings, produced using the most modern thermoplastic materials and manufacturing processes. These product ranges are known worldwide by the following trademarks: **NIRON, MULTINUPI, MULTIGECO, ELOFIT, ELOTHERM, ELOPRESS, POLYSYSTEM, POLIETILENE TUBI, SMARTFLEX, OILTECH, SMARTLPG, ELAMID, ELOSMART, SMARTCONDUIT,**



ECOWAVE, RACCORDI PVC and the **ELOSFERA** range dedicated to alternative energies: **NRGEO** and **ELOWEB**. These systems are known as real problem solving systems capable of supplying every kind of installation while reducing costs, avoiding wastes and increasing productivity. Thanks to their quality, these products positively fulfil the most stringent field tests and have obtained the most prestigious certifications, conforming to legislation from around the globe for water, gas networks and for the conveyance of fuels.

Producing better quality and being cost effective is the goal, which is made easier every day by new technology. **Nupi Industrie Italiane S.p.A.** is continuously investing in research and development programs, while strengthening the production systems, operated by a sophisticated technology that guarantees the highest quality of its products. The company's market leadership enforces its role in extremely competitive and technological fields such as the thermo-transformation of plastics and polymers.

THE PRODUCT

ELOPRESS compression fitting range complete the **ELOFIT** and **PE PIPES** ranges for the conveyance of drinking water and alimentary fluids and are suitable for high, medium and low density PE pipes at a maximum operating temperature of 40°C (80°C for drainage). They comply with **UNI 9561** and **DGGW GW 355-B3** Standards.

ELOPRESS fittings are suitable for:

- **Distribution of drinking water**
 - **Conveyance of fluids for human consumption**
 - **Fire prevention networks**
 - **Pressure systems**
 - **Irrigation networks**

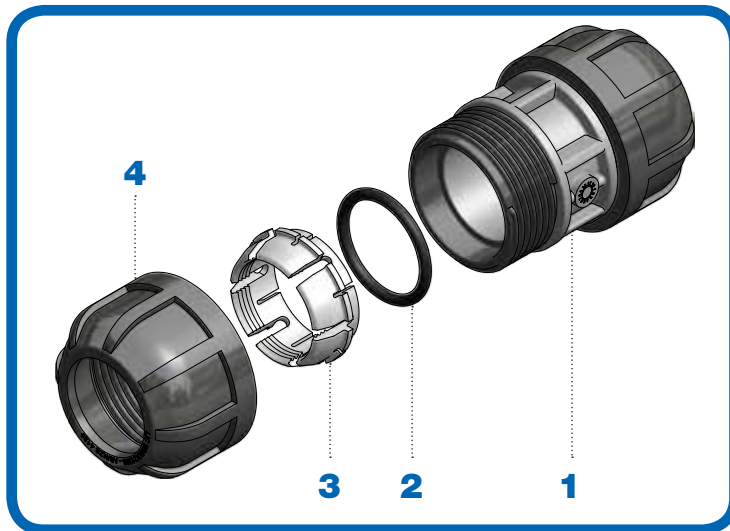

ELOPRESS compression fittings allow mechanical junction from Ø 16 mm up to Ø 110 mm and are composed as follows:

- 1 Body**
Solid and robust, designed to ensure maximum reliability and resistance, while maintaining compact size and ease of installation.
- 2 Gasket**
The compression it exerts on the pipe ensures the perfect hydraulic seal in the toughest working conditions, both for pressure and drainage systems.
- 3 Tightening ring**
Its conical shape ensures perfect mechanical seal by clinging to the pipe when you screw the ring nut.
- 4 Ring nut**
Its special design guarantees ease of installation and safety even in case of external stress on the pipe.



THE PRODUCT

The **ELOPRESS** product range is completed by a wide selection of clamp saddles from \varnothing 25 to \varnothing 160 mm. They are available both in standard version and with Stainless Steel ring and are composed of two polypropylene parts, held together by bolts, and a nitril rubber gasket that ensures a perfect seal.

- 1 Bolts and nuts**
- 2 Base**
- 3 Gasket**
- 4 Upper part with outlet**
- 5 Ring nut**

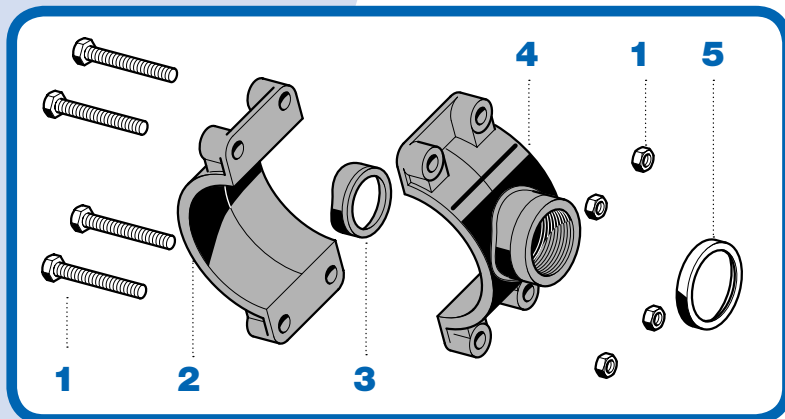

THE MATERIAL

- **Nominal pressure**
PN16 (16 bars) fittings \varnothing 16-63 mm
PN10 (10 bars) fittings \varnothing 75-110 mm
PN10 clamp saddles
- **Temperature**
Pressure: up to 40°C
Drainage: up to 80°C
- **Health prescriptions**
ELOPRESS fittings meet the **Standards for the conveyance of drinking water and fluids for human consumption** according to the regulations in force in Italy.
Ministerial Decree 174/2004 by the Ministry of Health.

CHARACTERISTICS

- **Body**
Black polypropylene
- **Ring nut**
Black polypropylene
- **Gasket**
70 Shore NBR nitril rubber
- **Tightening ring**
White polyacetal
- **Reinforced ring**
"AISI 430" Stainless Steel



INSTALLATION

CUT THE PIPE WITH THE SUITABLE PIPE CUTTER CHAMFER AND CLEAN THE PIPE BEFORE THE INSTALLATION

COMPRESSION FITTINGS Ø 16-63 mm

Unscrew the ring nut and the split ring while leaving them on the fitting body.

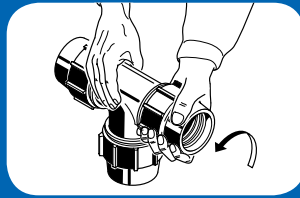

Insert the pipe into the fitting body and the o-ring until it reaches a complete stop.

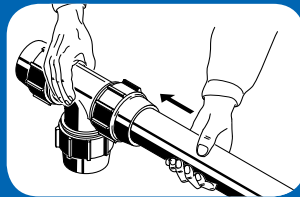

Screw the ring nut on the fitting body.

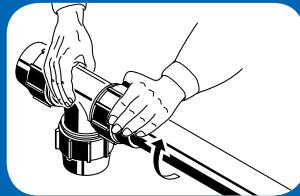

Use a wrench to completely tighten the ring nut.

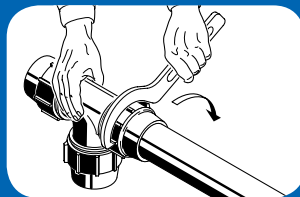

COMPRESSION FITTINGS Ø 75-110 mm

Unscrew the ring nut, the split ring, the thrust ring and the o-ring from the fitting.

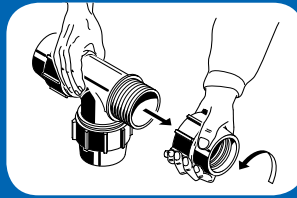

Insert the pipe into the ring nut, the thrust ring and the o-ring.

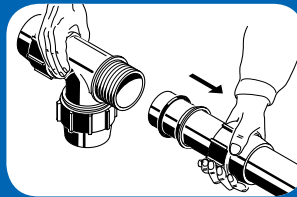

Lubricate the pipe end and insert it into the fitting body until it reaches a complete stop. Push the o-ring and the thrust ring inside the fitting body.

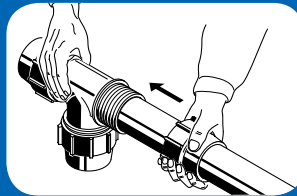

Screw the ring nut on the fitting body.

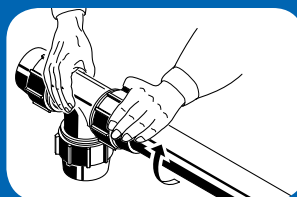

Unscrew the nut from the fitting body.

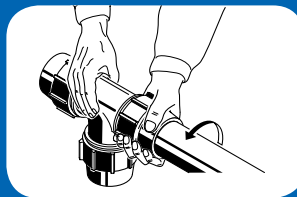

Place the split ring on the pipe until it reaches a complete stop.

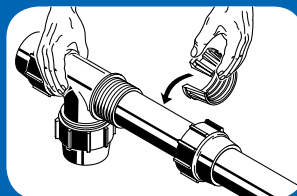

Use a wrench to completely tighten the nut.

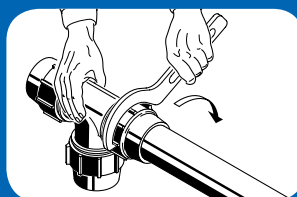

INSTALLATION

CUT THE PIPE WITH THE SUITABLE PIPE CUTTER CHAMFER AND CLEAN THE PIPE BEFORE THE INSTALLATION

CLAMP SADDLES Ø 25-160 mm:

Select the installation point and make sure that the outer surface of the pipe that is in contact with the gasket has no scratch, cut or other imperfections.

Position the bottom half of the saddle on the previously selected area of the pipe.

Connect the top half of the saddle with the bottom part.

Insert the bolts from the bottom.

Screw the nuts by using a criss-cross tightening sequence.

Drill the pipe. Be careful not to damage the thread of the saddle and the gasket. Use a spacer to avoid perforating the pipe on the other side. We recommend to use hole drill bits.

Alternatively, once the saddle has been assembled, remove it and mark the points which correspond to the position of the saddle with a white marker.

Remove the saddle.

Drill the pipe and remove any PE shaving from inside the pipe.

Assemble the clamp saddle again according to the position previously marked. Use a pin to keep the outlet aligned with the hole.

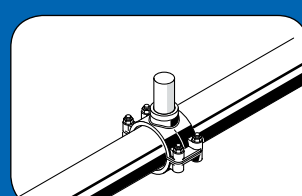
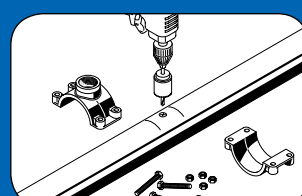
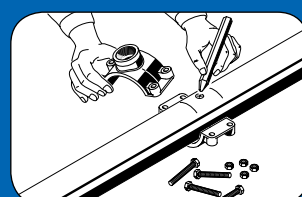
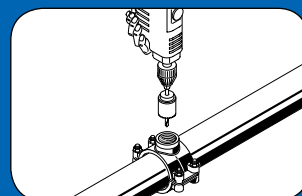
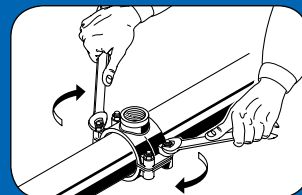
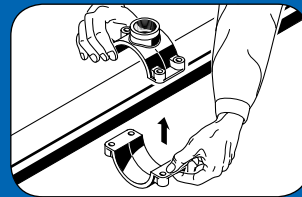

THE RANGE

FITTINGS

MALE ADAPTOR

CODE	Ø
10KRFM	FROM 16-3/8" TO 110-4"

FEMALE ADAPTOR

CODE	Ø
10KRFF	FROM 16-1/2" TO 110-4"

COUPLER

CODE	Ø
10KMAN	FROM 16 TO 110

REDUCING COUPLER

CODE	Ø
10KR	FROM 20-16 TO 110-90

90° TEE

CODE	Ø
10KT	FROM 16 TO 110

REDUCING 90° TEE

CODE	Ø
10KTR	FROM 25-20-25 TO 110-90-110

MALE THREADED 90° TEE

CODE	Ø
10KTM	FROM 20-1/2" TO 110-4"

FEMALE THREADED 90° TEE

CODE	Ø
10KTF	FROM 16-1/2" TO 110-4"

90° ELBOW

CODE	Ø
10KG	FROM 16 TO 110

FEMALE THREADED 90° ELBOW

CODE	Ø
10KGF	FROM 16-1/2" TO 110-4"

MALE THREADED 90° ELBOW

CODE	Ø
10KGM	FROM 16-3/8" TO 110-4"

END CAP

CODE	Ø
10KTAPPO	FROM 16 TO 110

FLANGED FITTING

CODE	Ø
10KRFL	FROM 50-1 1/2" TO 160-5"

WRENCH FOR RING NUT TIGHTENING

CODE	Ø
00CHIAVE	FROM 25 TO 110

KIT OF WRENCHES

CODE	Ø
00CKIT	25÷63 - 75÷110 - 25÷110

CLAMP SADDLES

CLAMP SADDLE

CODE	Ø
10KPS (A)	FROM 25 X 1/2" TO 50 X 1 1/4"
10KPS (B)	FROM 63 X 1/2" TO 90 X 2"
10KPS (C)	FROM 110 X 1/2" TO 160 X 3"

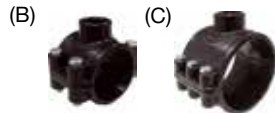

CLAMP SADDLE WITH RING STIFFENING

CODE	Ø
10KPSX (A)	FROM 25 X 1/2" TO 50 X 1 1/4"
10KPSX (B)	FROM 63 X 1/2" TO 90 X 2"
10KPSX (C)	FROM 110 X 1/2" TO 160 X 3"



DOUBLE CLAMP SADDLE

CODE	Ø
10KPSD (A)	FROM 25 X 1/2" TO 50 X 1 1/4"
10KPSD (B)	FROM 63 X 1/2" TO 90 X 2"
10KPSD (C)	FROM 110 X 1/2" TO 160 X 3"

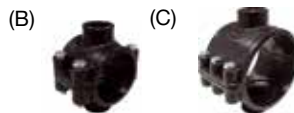

DOUBLE CLAMP SADDLE WITH RING STIFFENING

CODE	Ø
10KPSDX (A)	FROM 25 X 1/2" TO 50 X 1 1/4"
10KPSDX (B)	FROM 63 X 1/2" TO 90 X 2"
10KPSDX (C)	FROM 110 X 1/2" TO 160 X 3"



TRANSITION SYSTEMS

TRANSITION COUPLER

CODE	Ø
10KRAMAN	25 X 22 MM

TRANSITION COUPLER

CODE	Ø
10KARAMAN	FROM 16 X 1/2" TO 32 X 3/4"

TRANSITION ELBOW

CODE	Ø
10KARAG	FROM 20 X 1/2" TO 25 X 3/4"

TRANSITION TEE

CODE	Ø
10KARAT	FROM 20 X 1/2" TO 25 X 3/4"

TRANSITION BRASS 90° ELBOW THREADED FEMALE WITH HANGER AND PE COMPRESSION CONNECTION

CODE	Ø
10KAWP	FROM 20 X 1/2" TO 25 X 3/4"



PE/COPPER TRANSITION KIT

CODE	Ø
10KARAKIT	FROM 20 X 1/2" TO 32 X 1"



'VITON PVC' KIT

CODE	Ø
10KAPVCKIT	FROM 16 TO 110



SPARE PARTS

RING NUT

CODE	Ø
20KGH (1)	FROM 16 TO 40
20KGH (2)	FROM 50 TO 110



GASKET

CODE	Ø
20KORR	FROM 16 TO 40



SPLIT RING

CODE	Ø
20PINZA	FROM 16 TO 110



THRUST RING

CODE	Ø
20KANELLO	FROM 16 TO 110



GASKET FOR CLAMP SADDLES

CODE	Ø
20KORS	FROM 25 TO 125/160





Registered Office and Headquarters

via Stefano Ferrario 8
21052 Busto Arsizio (VA) Italy
Ph. +39 0331-344211
Fax +39 0331-351860
info@nupinet.com
www.nupiindustriaitaliane.com

Production, Operations and Administration Centre

via dell'Artigianato 13
40023 Castel Guelfo (BO) Italy
Ph. +39 0542-624911
Fax +39 0542-670851
info@nupinet.com
www.nupiindustriaitaliane.com

Production Facility

via Colombarotto 58
40026 Imola (BO) Italy
Ph. +39 0542-624911
Fax +39 0542-670851
info@nupinet.com
www.nupiindustriaitaliane.com



www.nupiindustriaitaliane.com